

**ELEVATION**  
SCALE 1:10

- NOTES:
1. BRICKS TO BE LAID IN A STRETCHER BOND PATTERN IN ACCORDANCE WITH DESIGN PLANS.
  2. MINIMUM COMPRESSIVE CONCRETE STRENGTH TO BE 32MPa AFTER 28 DAYS.
  3. CHAIRS SHALL SUPPORT THE MESH AT 900mm CENTRES.
  4. APPROVED EXPANSION MATERIAL TO BE PLACED BETWEEN BRICKS AND EXISTING OR NEW CONCRETE E.G. KERB AND CHANNEL.
  5. IN CASES WHERE POOR SUBGRADE CONDITIONS EXIST, CONSIDERATION TO BE GIVEN TO SUBGRADE STABILISATION OR REPLACEMENT.

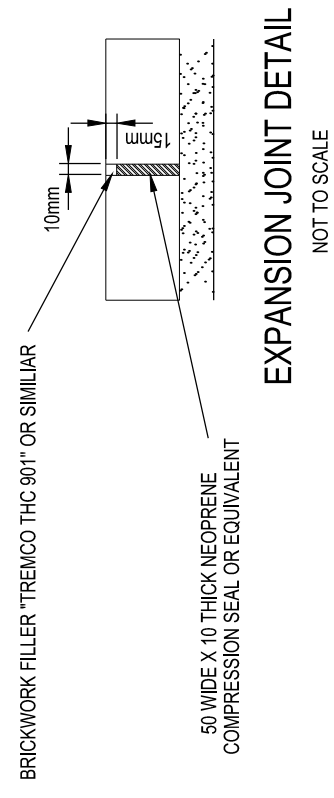

**MORNINGTON PENINSULA**  
*Shire*

**STANDARD PLAN**  
BRICK ROAD PAVING ON CONCRETE BASE

*[Signature]*  
MANAGER - INFRASTRUCTURE PROJECTS

DATE OF ISSUE 10/01/2025  
SHEET NO 1 OF 1

**MP811**