

NOTES:

- 1 FOR BEDDING, SEE CLAUSE F4 OF THE MORNINGTON PENINSULA SHIRE SPECIFICATION.
Link: www.mornpen.vic.gov.au/Building-Planning/Engineering/Construction-of-Roads-Drains
- 2 SMOOTH TROWEL FINISH
- 3 TOOL JOINTS ONLY, NO SAW CUTS
- 4 CHANNEL OR TRAY MUST BE REMOVED FOR ALL REPLACEMENT OR REINSTATEMENT WORKS.
- 5 ALL REPLACEMENT OR REINSTATEMENT WORKS MUST BE DOWELLED INTO EXISTING KERB USING N12 BARS AT 450MM LENGTHS, WITH 150MM DRILLED INTO EXISTING KERB.
- 6 ALL MEASUREMENTS ARE IN MILLIMETRES.

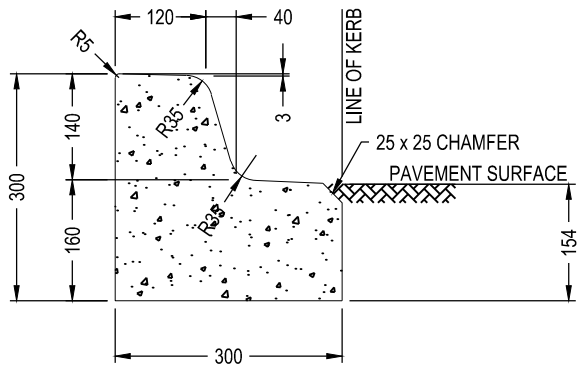

BK1: BARRIER KERB FOR ONEWAY CROSSFALL

SCALE 1:10

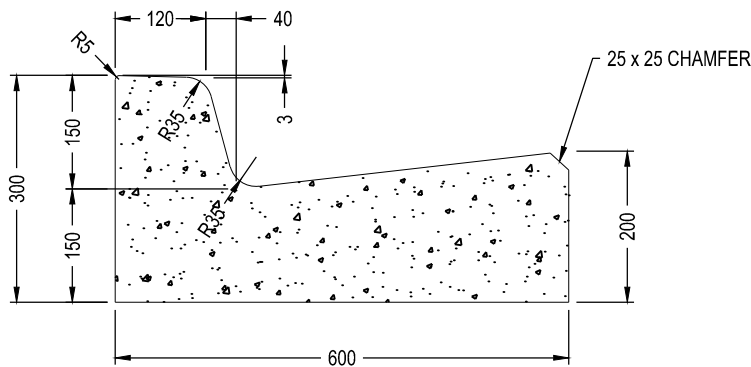

BK2: BARRIER KERB & CHANNEL

SCALE 1:10

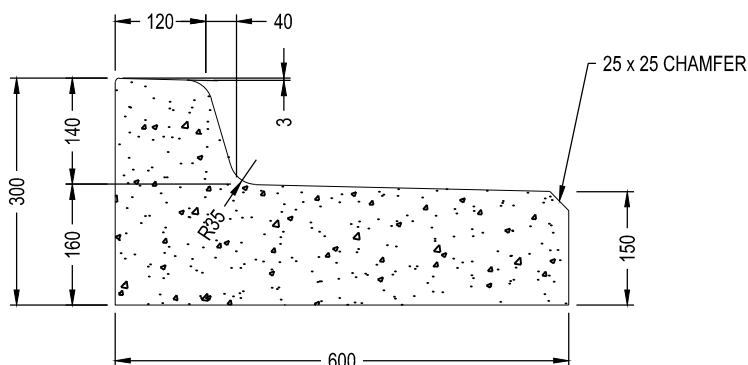

BK3: BARRIER KERB & TRAY

SCALE 1:10



**MORNINGTON
PENINSULA**
Shire

**STANDARD PLAN
BARRIER KERB PROFILES**

[Signature]

MANAGER - INFRASTRUCTURE PROJECTS

**DATE OF ISSUE
SHEET NO**

**05/12/2024
1 OF 1**

MP102