

# QA23021 - BLACKSPOT - RAISED SAFETY PLATFORMS DUNNS ROAD BETWEEN MORNINGTON-TYABB ROAD AND CRAIGIE ROAD, MOUNT MARTHA

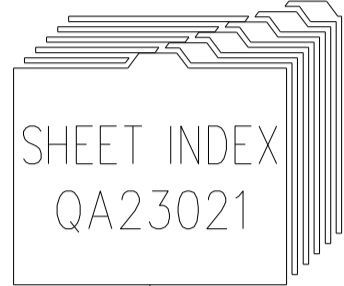

PLAN NUMBER	DESCRIPTION
23021-01	TITLE PAGE, LOCALITY PLAN AND SHEET INDEX
23021-02	GENERAL NOTES
23021-03	TYPICAL DETAILS - RAISED SAFETY PLATFORMS AND TRAFFIC SIGNS
23021-04	PROPOSED RAISED SAFETY PLATFORMS AT DUNNS ROAD SITE 1&2
23021-05	PROPOSED RAISED SAFETY PLATFORMS AT DUNNS ROAD SITE 3&4
23021-06	PROPOSED RAISED SAFETY PLATFORMS AT DUNNS ROAD SITE 5

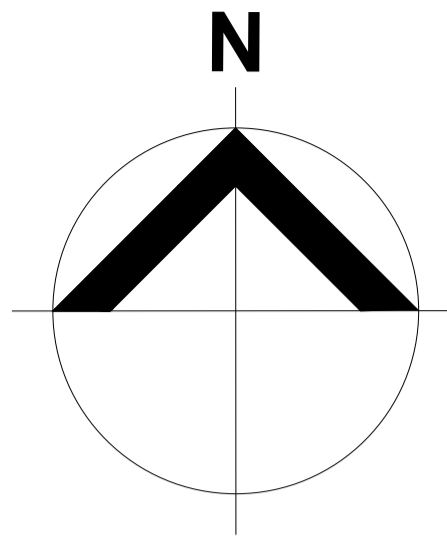
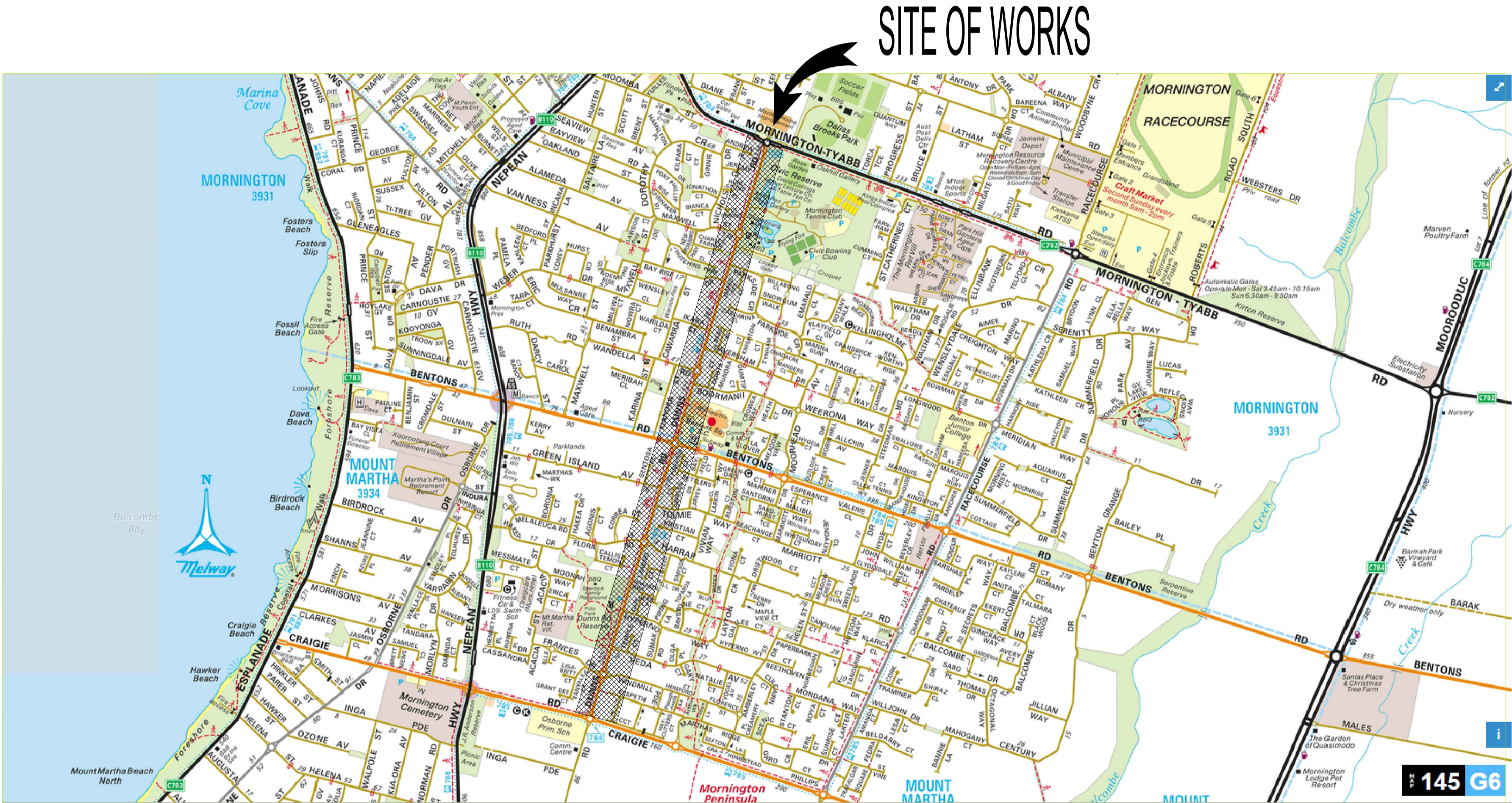

LOCALITY PLAN  
NOT TO SCALE

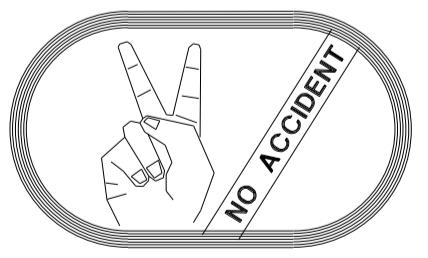

**NOTE**  
**TRAFFIC MANAGEMENT**  
CONTRACTOR TO SUBMIT TRAFFIC MANAGEMENT PLAN WITH APPLICATION FOR APPROVAL OF TRAFFIC MANAGEMENT PLAN. REFER TO ATTACHED TENDER DOCUMENTS.

THE CONTRACTOR SHALL BE TOTALLY RESPONSIBLE FOR AND AT ALL TIMES PROVIDE A SAFE WORKING ENVIRONMENT IN THE VICINITY OF THE SITE OF WORKS IN FULL COMPLIANCE WITH THE OCCUPATIONAL HEALTH AND SAFETY REGULATIONS.

**WARNING**  
**BWARE OF UNDERGROUND SERVICES**  
THE LOCATION OF EXISTING SERVICES SHOWN ON THESE PLANS ARE APPROXIMATE ONLY AND THEIR EXACT POSITION SHALL BE PROVEN ON SITE. THE APPROPRIATE AUTHORITY SHALL BE CONTACTED AND THE SERVICES LOCATED PRIOR TO COMMENCEMENT OF ANY WORKS. NO GUARANTEE IS GIVEN THAT ALL EXISTING SERVICES ARE SHOWN.

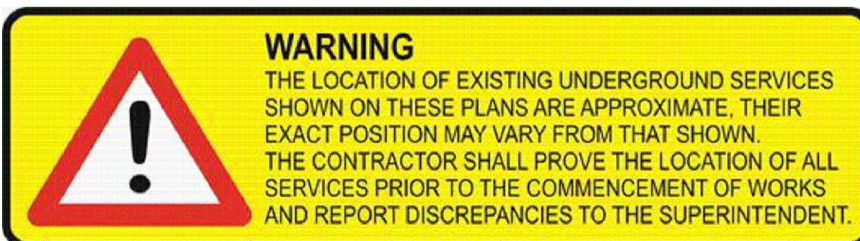

**NOTE**  
CONTRACTOR TO EXCAVATE & OPEN PROPOSED PIPE TRENCH TO CONFIRM ALL SERVICE CROSSINGS PRIOR TO CONSTRUCTION/ LAYING OF REINFORCED CONCRETE PIPES.



**TO CONSTRUCT**

LEGEND			
	TELSTRA POLE		FIRE HYDRANT
	TELSTRA PIT		WATER STOP VALVE
	PHONE BOX		GAS VALVE
	POWER POLE		SEWER MANHOLE
	LIGHT POLE		EX WATER MAIN
	LANTERN		EX GAS MAIN
	UNDERGROUND POWER PIT		EX U/GROUND TELSTRA CABLE
	FIRE PLUG		EX SEWER MAIN
	PROPOSED KERB AND CHANNEL		EXISTING KERB AND CHANNEL
	PROPOSED WATER MAIN		TREE
	PROPOSED GAS MAIN		TREE TO BE REMOVED
	PROPOSED U/G TELSTRA CABLE		PROPOSED DRAINAGE
	PROPOSED SEWER MAIN		EXISTING DRAINAGE
	PROPOSED U/G ELECTRICITY CABLE		PIT NUMBER
	PERMANENT SURVEY MARK		PROPOSED HOUSE DRAIN
	EXISTING HOUSE DRAIN		PROPOSED PROPERTY INLET

PLAN APPROVED  
SIGNED \_\_\_\_\_  
DEREK ROTTER  
MANAGER  
PROJECT DELIVERY

NO	DATE	BY	DRAWING REVISION DETAILS
C1		C2	
B1		B2	
A	20/09/23	BY	PRELIMINARY

COMPUTER REFERENCE	
PROJECT QA:	23021
CONTRACT CN:	2436
CIVIL 3D DWG:	23021
SURVEY:	SURVEYOR
DESIGN:	PS
DRAWN:	PS
CHECKED:	



DUNNS ROAD  
MOUNT MARTHA  
BLACKSPOT - RAISED SAFETY PLATFORMS  
TITLE PAGE, LOCALITY PLAN, SHEET INDEX

DATUM:	A.H.D.
SCALE AT A1:	AS SHOWN
DATE OF PLAN:	20-02-2024
MELWAYS REF:	145G4
SHEET No. 01 OF 06	
PLAN REF No.	REV
23021-01	A

- ALL WORKS ARE TO BE CARRIED OUT IN ACCORDANCE WITH AS2124-1992 GENERAL CONDITIONS OF CONTRACT, THE CURRENT MORNINGTON PENINSULA SHIRE SPECIFICATIONS AND STANDARD DRAWINGS, AND TO THE SATISFACTION OF THE SUPERINTENDENT.
- THE MORNINGTON PENINSULA SHIRE AND ALL SERVICE AUTHORITIES SHALL BE NOTIFIED IN WRITING A MINIMUM OF SEVEN (7) CLEAR DAYS PRIOR TO THE COMMENCEMENT OF ANY WORKS.
- ALL LEVELS SHOWN ARE TO A.H.D. AND DIMENSIONS IN METRES UNLESS OTHERWISE NOTED.
- UPON COMMENCEMENT OF CONSTRUCTION WORKS THE CONTRACTOR MUST COMPLY WITH THE RECOMMENDATIONS OF THE ENVIRONMENT PROTECTION AUTHORITY PUBLICATION 'CONSTRUCTION TECHNIQUES FOR SEDIMENT POLLUTION CONTROL'.
- WARNING** THE LOCATION OF EXISTING SERVICES SHOWN ON THESE PLANS ARE APPROXIMATE AND THEIR EXACT LOCATION SHALL BE PROVEN ON SITE BY THE CONTRACTOR PRIOR TO THE COMMENCEMENT OF ANY WORKS. DISCREPANCIES SHALL BE REPORTED TO THE SUPERINTENDENT
- UNDERGROUND GAS, TELSTRA, ELECTRICITY, SEWER & WATER ASSETS EXIST WITHIN THE SCOPE OF THESE WORKS. ANY DAMAGE CAUSED TO EXISTING SERVICES AND ANY COSTS ASSOCIATED WITH REPAIRS OR LOSS ARE THE RESPONSIBILITY OF THE CONTRACTOR.
- UNLESS OTHERWISE SHOWN NO TREES SHALL BE REMOVED OR TRIMMED WITHOUT THE PRIOR CONSENT OF THE SUPERINTENDENT
- ALL STORMWATER AND CONDUIT TRENCHES UNDER ROAD PAVEMENT AND/OR KERB & CHANNEL AND/OR CONCRETE PAVING SHALL BE BACKFILLED WITH 20mm CLASS 3 F.C.R AS SPECIFIED, AND COMPACTED IN 150mm LAYERS.
- THE CONTRACTOR IS TO ENSURE THAT A MINIMUM OF 300mm OF FCR IS PLACED OVER ALL DRAINAGE PIPES UNDER TRAFFICABLE AREAS DURING CONSTRUCTION.
- ALL STORMWATER DRAINAGE PIPES SHALL BE CLASS '2' R.C.P. AND RUBBER RING JOINTED UNLESS OTHERWISE SPECIFIED.
- ALL STORMWATER DRAINAGE PITS AND PROPERTY CONNECTIONS etc ARE TO BE CONSTRUCTED IN ACCORDANCE WITH THE MORNINGTON PENINSULA SHIRES STANDARD DRAWINGS & SPECIFICATION.
- THE CONTRACTOR IS RESPONSIBLE FOR THE REMOVAL AND DISPOSAL OF ALL RUBBISH AND SPOIL FROM THE SITE.
- NO TOPSOIL SHALL BE REMOVED FROM THE SITE WITHOUT CONSENT FROM THE SUPERINTENDENT.
- EARTHWORKS SHALL BE CARRIED OUT TO DESIGN LEVELS SHOWN ON CONSTRUCTION ISSUE PLANS. CUT BATTERS TO BE 1 IN 3, FILL BATTERS 1 IN 6 UNLESS SHOWN OTHERWISE.
- FILL AREAS GREATER THAN 200mm SHALL BE STRIPPED OF TOP SOIL AND VEGETATION, APPROVED FILL MATERIAL PLACED AND TOPSOILED TO OBTAIN FINAL FILL LEVELS AS SHOWN ON CONSTRUCTION ISSUE PLANS.
- FILL MATERIAL TO BE PLACED IN 150mm LAYERS AND COMPACTED TO MINIMUM 95% DRY DENSITY (STANDARD COMPACTION TEST)
- STRUCTURAL FILL MATERIAL IS TO BE APPROVED BY COUNCIL PRIOR TO PLACEMENT. LEVEL 1 GEOTECHNICAL SUPERVISION IS TO BE MAINTAINED TO AS3798-1996, COMPACTED IN 150mm LAYERS ALL AS SPECIFIED.
- ALL FILL, NATURE STRIPS, VERGES, BATTERS AND DISTURBED AREAS SHALL BE TOPSOILED WITH 75mm MINIMUM DEPTH OF APPROVED LOAM AND SOWN WITH SEED, ALL AS SPECIFIED.
- EARTHWORKS WITHIN ROAD RESERVES SHALL BE TESTED TO THE REQUIREMENTS AND SATISFACTION OF THE MORNINGTON PENINSULA SHIRE COUNCIL. THE CONTRACTOR SHALL ENGAGE THEIR OWN 'NATA' REGISTERED GEOTECHNICAL ENGINEER TO CARRY OUT TESTS IN ACCORDANCE WITH AS3798 AND AS1289 AND SHALL SUPPLY TEST RESULTS CONFIRMING WITH THE PROJECT SPECIFICATION. FREQUENCY OF TESTS WILL BE PROVIDED IN ACCORDANCE WITH AS3798. TEST RESULTS TO BE REVIEWED BY THE MORNINGTON PENINSULA SHIRE COUNCIL, AND IF NECESSARY ADDITIONAL TESTS WILL BE SUPPLIED TO THE SUPERINTENDENT SATISFACTION.
- PRE MIX CONCRETE TO HAVE A 28 DAY STRENGTH OF 25MPa UNLESS OTHERWISE NOTED.
- ALL KERB & CHANNEL TO BE IN ACCORDANCE WITH MORNINGTON PENINSULA SHIRE STANDARD DRAWINGS.
- ALL LAYBACKS & PRAM CROSSINGS TO BE IN ACCORDANCE WITH MORNINGTON PENINSULA SHIRE STANDARD DRAWINGS.
- UNLESS OTHERWISE SHOWN ALL CHAINAGES SHOWN ARE TO THE DESIGN CENTRE LINE OF ROAD PAVEMENT.
- ALL KERB RADII SHOWN ARE TO LIP OF KERB ie R7.0. RADII TO BACK OF KERB SHOWN BEHIND KERB IN BRACKETS ie. (R6.4).
- THE CONTRACTOR SHALL ERECT AND IS RESPONSIBLE FOR MAINTAINING ALL SHORING, PLANKING, STRUTTING, Dewatering, BARRICADES, WARNING SIGNS, LIGHTS etc NECESSARY TO KEEP THE WORK SITE SAFE AND TO PROTECT THE PUBLIC FROM THE WORKS.
- ALL LINEMARKING AND SIGNAGE IS TO BE INSTALLED IN ACCORDANCE WITH AS1742-1 AND AS1742-2 UNLESS SPECIFICALLY SHOWN OTHERWISE. LINEMARKING IS TO BE INSTALLED USING EXTRUDED LONG LIFE THERMOPLASTIC PAINT.

- THE PAVEMENT DEPTH SPECIFIED IS A MINIMUM DEPTH, AND MAY BE VARIED BY THE SUPERINTENDENT. WHERE DIRECTED SOFT SPOTS SHALL BE EXCAVATED TO A HARD BASE AND BACKFILLED WITH APPROVED GRANULAR MATERIAL IN 150mm LAYERS.
- THE SUBGRADE OF ALL PAVEMENTS SHALL BE APPROVED BY COUNCIL'S SUPERINTENDENT PRIOR TO PLACEMENT OF ANY SUBSEQUENT PAVEMENT COURSE. PROOF ROLLING AND COMPACTION TESTING OF EACH PAVEMENT LAYER SHALL BE IN ACCORDANCE WITH AS3798 AND AS1289 AND SHALL MEET THE FOLLOWING STANDARDS:  
 ASPHALT LAYERS < 50mm 94.5% MEAN DENSITY RATIO, 93% CHARACTERISTIC DENSITY RATIO  
 ASPHALT LAYERS > 50mm 96% MEAN DENSITY RATIO, 95% CHARACTERISTIC DENSITY RATIO  
 BASE LAYER 98% MODIFIED DRY DENSITY  
 SUB BASE LAYER 95% MODIFIED DRY DENSITY  
 SUB GRADE LAYER 95% STANDARD DRY DENSITY  
 COMPACTION TEST RESULTS SHALL BE FORWARDED TO COUNCIL SUPERINTENDENT FOR APPROVAL PRIOR TO PLACEMENT OF SUBSEQUENT PAVEMENT LAYERS.
- ALL ROADS USED BY TRUCKS AND CONSTRUCTION EQUIPMENT ARE TO BE KEPT CLEAN AT ALL TIMES TO THE SATISFACTION OF THE SUPERINTENDENT
- THE CONTRACTOR SHALL ENSURE THAT DUST PRODUCED FROM THE SITE SHALL BE KEPT TO A MINIMUM, AND NOT CAUSE A NUISANCE TO ANY THIRD PARTY.
- THE CONTRACTOR IS REQUIRED TO CONFINE CONSTRUCTION VEHICLES TO THE ROAD RESERVE AND EASEMENTS. ANY DAMAGE CAUSED TO SURROUNDING ALLOTMENTS OR PROPERTIES MUST BE MADE GOOD.
- UPON THE COMPLETION OF WORKS THE CONTRACTOR IS TO CLEAN UP AND FLUSH ALL DRAINAGE PIPES TO THE SATISFACTION OF THE SUPERINTENDENT
- WHERE A DISCREPANCY MAY ARISE BETWEEN THE CONSTRUCTION ISSUE PLANS AND THE PROJECT SPECIFICATION, THE SPECIFICATION TAKES PRECEDENCE. SUCH DISCREPANCY'S MUST BE REPORTED TO THE SUPERINTENDENT.
- EXISTING SERVICE CONDUITS FOR GAS, WATER AND ELECTRICITY ARE TO BE REFERENCED IN 50mm HIGH LETTERS ON THE FACE OF KERB AND CHANNEL MARKED WITH EITHER 'G', 'W', OR 'E' ACCORDINGLY.
- EXISTING PROPERTY SERVICE TAPPINGS FOR GAS & WATER ARE TO BE LOCATED BY HAND EXCAVATION PRIOR TO THE COMMENCEMENT OF ROAD BOXING OUT. ANY DISCREPANCY'S WITH THE DESIGN MUST BE REPORTED TO THE SUPERINTENDENT
- ORIGIN ENERGY'S "RECORDS OF UNDERGROUND MAINS AND PROTECTION OF ASSETS" STATEMENT SHALL BE READ AND COMPLIED WITH DURING THE CONSTRUCTION WORKS. IT IS NOTED THAT THE FOLLOWING MINIMUM CLEARANCES FROM ORIGIN ENERGY'S RETICULATION MAINS AND SERVICES SHOULD BE MAINTAINED.  
 - 150mm when crossing gas mains with installations up to 1.50 metres wide.  
 - 300mm when crossing gas mains with installations greater than 1.50 metres wide.  
 - 300mm when installations are laid parallel to gas mains. (Excluding electrical underground cables).  
 - 600mm between all gas mains and earthing stakes.  
 - 300mm between all domestic gas services and parallel electrical underground cables.  
 - 1000mm between all gas mains and parallel electrical underground cables.
- EXISTING SOUTH EAST WATER ASSETS EXIST WITHIN THE PROPOSED SCOPE OF WORKS, AND THE FOLLOWING CONDITIONS ARE TO BE COMPLIED AND ADHERED WITH:  
**WATER**  
 - Minimum cover required over water mains during construction is 450mm.  
 - The minimum final cover over water mains is 450mm (nature strips), 600mm (sealed roads), 750mm (major roads), 1200mm (freeways) the location and depth of water mains is to be proved by hand excavation prior to the commencement of the works where required;  
 - The minimum verticle clearance between water mains and drains is 150mm.  
 - Drains crossing over water mains are to be designed as a pier and beam arrangement.  
 - The minimum horizontal clearance between water mains and other assets (including street furniture and kerb and channel) is 450mm.  
 - Surface fittings are to be accessible at all times to allow for emergency shut down of the mains and all surface fittings must be raised to suit finished surface levels.  
 Where there is a requirement to adjust surface fittings, please contact SEW  
**Standard Conditions**  
 When designing and constructing proposed assets within the vicinity of South East Water sewer asset, certain considerations need to be made:  
 For sewer pipes up to 225mm diameter, the following applies:  
 - No additional load is to be placed on sewer assets;  
 - All utilities / retaining walls are to cross sewers at 90°;  
 - A minimum vertical clearance of 300mm is required;  
 - Proposed structures / assets parallel to sewers are to be 600mm clear (horizontally) of closest edge of sewer;  
 - Maximum fill to be placed over a sewer is 1.0metre;  
 For sewer maintenance holes and maintenance shafts, the following applies:  
 - A minimum of 1.0metre horizontal clearance from edge of cover surround;  
 - No additional load is to be placed on sewer assets;  
 - Access is required 24 hours per day for maintenance purposes;
- EXISTING TELSTRA TELECOMMUNICATION ASSETS EXIST WITHIN THE PROPOSED SCOPE OF WORKS. IT IS RECOMMENDED THAT A "DIAL BEFORE YOU DIG - Phone 1100" SERVICES ASSET SEARCH BE DONE TO ASCERTAIN THE APPROXIMATE LOCATION & PLANS OF SERVICES PRIOR TO COMMENCEMENT OF WORKS. PLEASE GIVE AT LEAST 2 DAYS NOTICE. TELSTRA'S SUBSEQUENT "PLANT LOCATION DETAILS" & "DUTY OF CARE" STATEMENT IS TO BE READ AND ADHERED TO DURING THE CONSTRUCTION WORKS. FOR FURTHER ON SITE DETAILS PLEASE PHONE TELSTRA'S FIELD CONSULTANT MR. MICHAEL WILSON ON Ph.0429 919 343.
- EXISTING MELBOURNE WATER ASSETS EXIST WITHIN THE PROPOSED SCOPE OF WORKS. IN ACCORDANCE WITH MELBOURNE WATERS CORRESPONDENCE OF 18th APRIL 2008, THE CIVIL CONTRACTOR SHALL MAKE A 'WORK PERMIT' APPLICATION TO MW AND COMPLY WITH ALL MW WORK CONDITIONS IMPOSED.

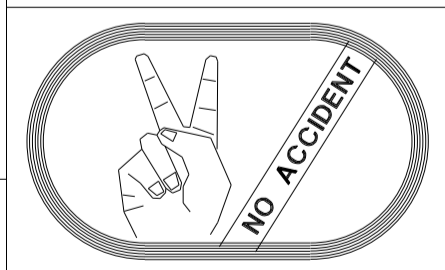

**NOTE**  
**TRAFFIC MANAGEMENT**  
 CONTRACTOR TO SUBMIT TRAFFIC MANAGEMENT PLAN WITH APPLICATION FOR APPROVAL OF TRAFFIC MANAGEMENT PLAN. REFER TO ATTACHED TENDER DOCUMENTS.

THE CONTRACTOR SHALL BE TOTALLY RESPONSIBLE FOR AND AT ALL TIMES PROVIDE A SAFE WORKING ENVIRONMENT IN THE VICINITY OF THE SITE OF WORKS IN FULL COMPLIANCE WITH THE OCCUPATIONAL HEALTH AND SAFETY REGULATIONS.

**WARNING**  
**BWARE OF UNDERGROUND SERVICES**  
 THE LOCATION OF EXISTING SERVICES SHOWN ON THESE PLANS ARE APPROXIMATE ONLY AND THEIR EXACT POSITION SHALL BE PROVEN ON SITE. THE APPROPRIATE AUTHORITY SHALL BE CONTACTED AND THE SERVICES LOCATED PRIOR TO COMMENCEMENT OF ANY WORKS. NO GUARANTEE IS GIVEN THAT ALL EXISTING SERVICES ARE SHOWN.

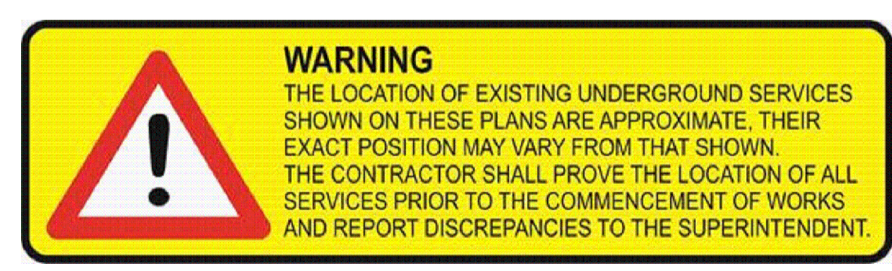

**NOTE**  
 CONTRACTOR TO EXCAVATE & OPEN PROPOSED PIPE TRENCH TO CONFIRM ALL SERVICE CROSSINGS PRIOR TO CONSTRUCTION/ LAYING OF REINFORCED CONCRETE PIPES.



**TO CONSTRUCT**

LEGEND			
	TELSTRA POLE		FIRE HYDRANT
	TELSTRA PIT		WATER STOP VALVE
	PHONE BOX		GAS VALVE
	POWER POLE		SEWER MANHOLE
	LIGHT POLE		EX WATER MAIN
	LANTERN		EX GAS MAIN
	UNDERGROUND POWER PIT		EX U/GROUND TELSTRA CABLE
	FIRE PLUG		EX SEWER MAIN
	EX U/GROUND ELECTRICITY CABLE		PROPOSED KERB AND CHANNEL
	EX OVERHEAD POWER CABLE		EXISTING KERB AND CHANNEL
	PROPOSED WATER MAIN		TREE
	PROPOSED GAS MAIN		TREE TO BE REMOVED
	PROPOSED U/G TELSTRA CABLE		PROPOSED DRAINAGE
	PROPOSED SEWER MAIN		EXISTING DRAINAGE
	PROPOSED U/G ELECTRICITY CABLE		PIT NUMBER
	PERMANENT SURVEY MARK		PROPOSED HOUSE DRAIN
	EXISTING HOUSE DRAIN		PROPOSED PROPERTY INLET

PLAN APPROVED	H		
	G		
	F		
	E		
	D		
	C		
	B		
DEREK ROTTER MANAGER	A	00/00/00	BY STAGE
PROJECT DELIVERY	No	DATE	BY
	DRAWING REVISION DETAILS		

COMPUTER REFERENCE	
PROJECT QA:	23021
CONTRACT CN:	2436
CIVIL 3D DWG:	23021
SURVEY:	SURVEYOR
DESIGN:	PS
DRAWN:	PS
CHECKED:	



DUNNS ROAD  
 MOUNT MARtha  
 BLACKSPOT - RAISED SAFETY PLATFORMS  
 GENERAL NOTES

DATUM:	A.H.D.
SCALE AT A1:	AS SHOWN
DATE OF PLAN:	20-02-2024
MELWAYS REF:	145G4
SHEET No. 02 Of 06	
PLAN REF No.	REV
23021-02	A

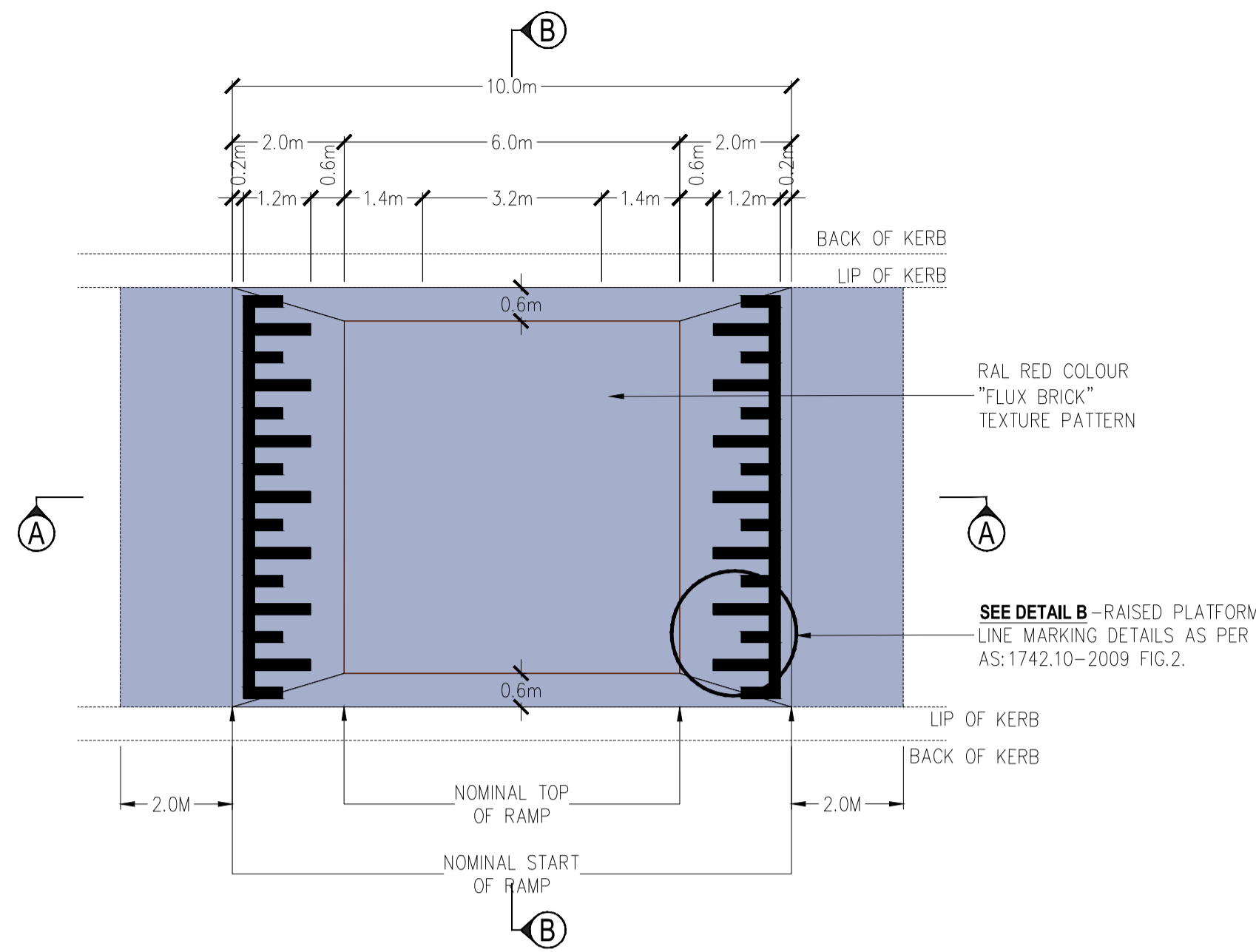

TYPICAL PLAN - FLAT-TOP ROAD HUMPS TYPE 1  
NOT TO SCALE

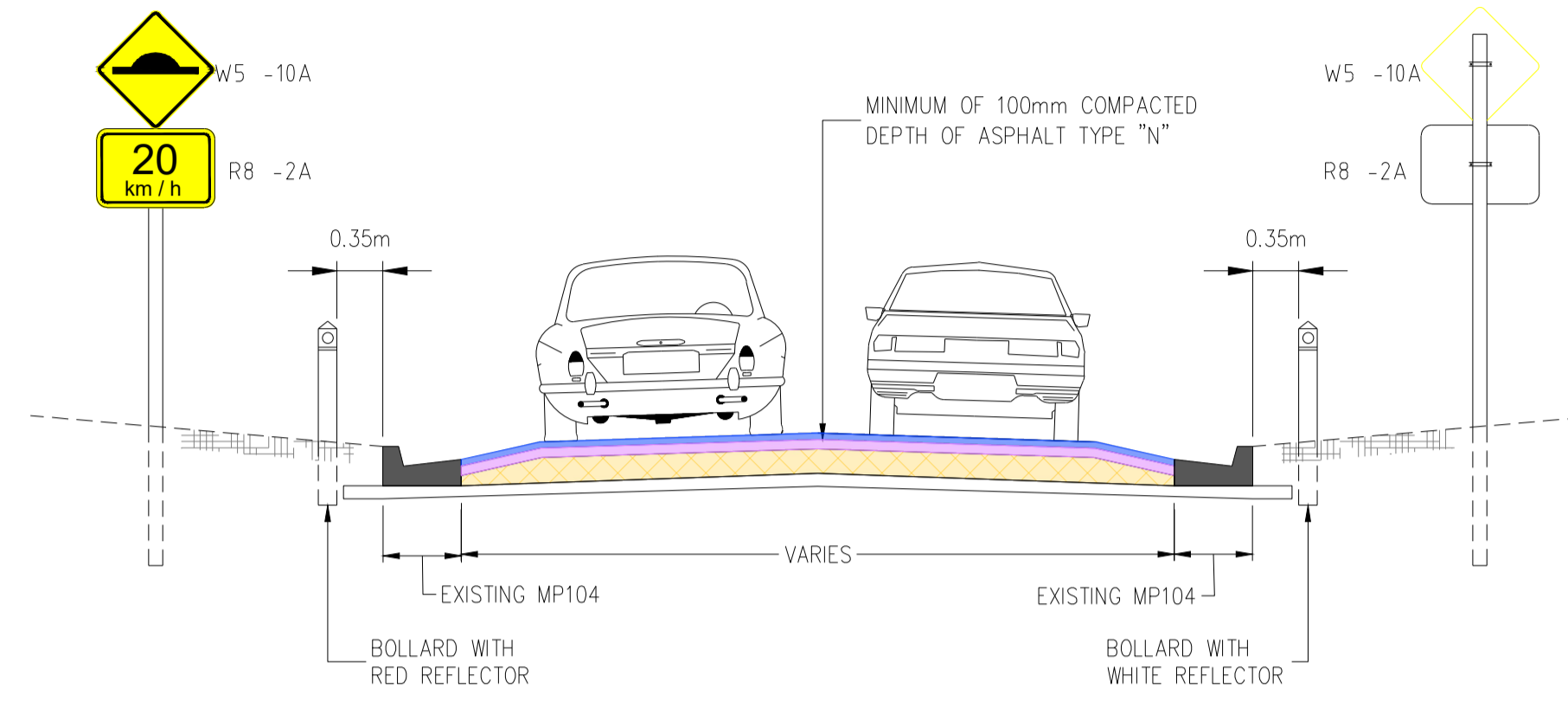

FLAT-TOP ROAD HUMPS - SECTION B-B  
NOT TO SCALE

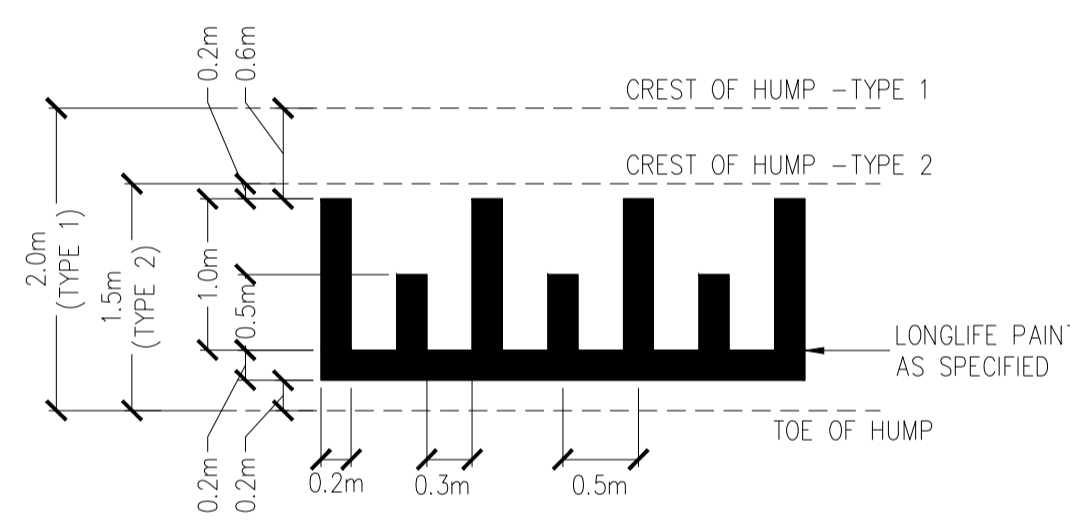

DETAIL B - RAISED PLATFORM LINEMARKING  
NOT TO SCALE

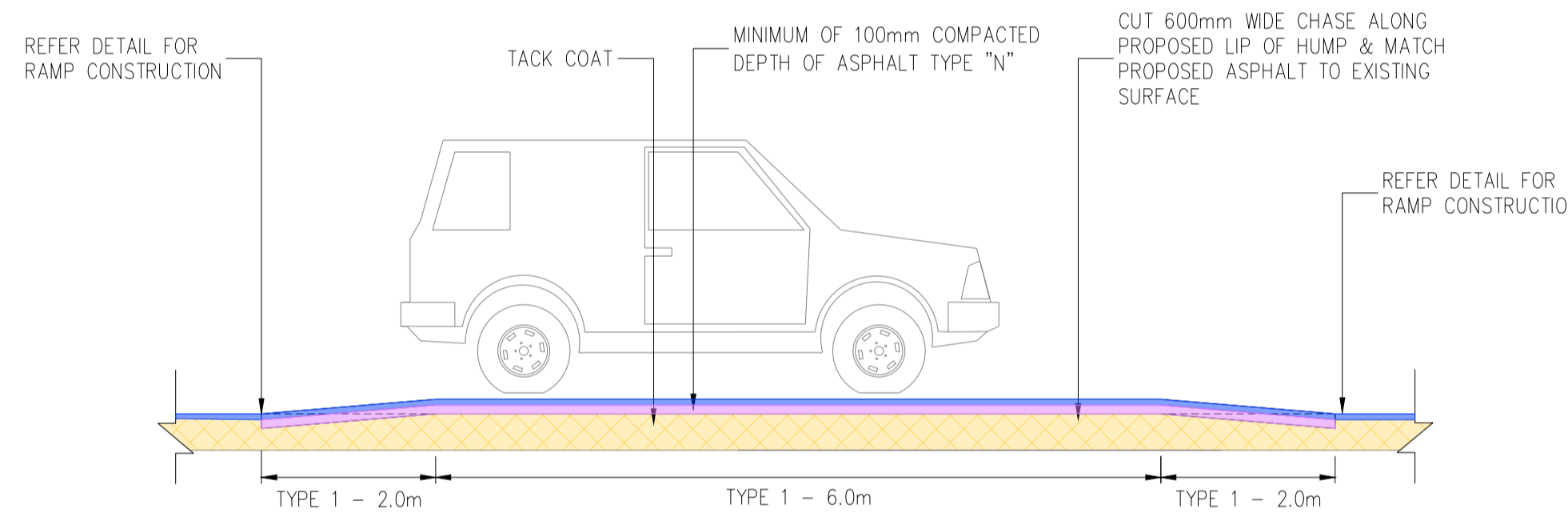

FLAT-TOP ROAD HUMPS TYPE 1 & 2 - SECTION A-A  
NOT TO SCALE

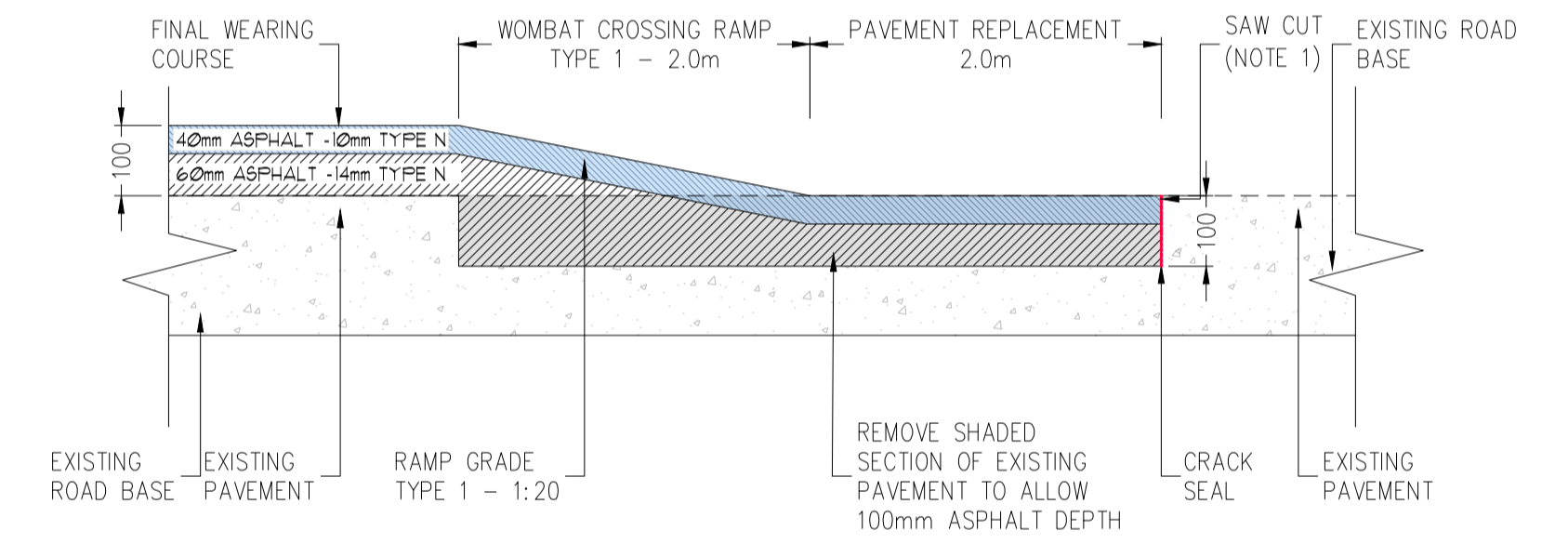

RAMP/PAVEMENT CONSTRUCTION DETAIL  
NOT TO SCALE

**NOTE:**

1. ANY KERB & CHANNEL THAT IS TO BE REMOVED IS TO BE NEATLY SAW CUT AT THE EDGE OF THE MODIFIED KERB & CHANNEL. IF THE REMAINING SECTION OF KERB & CHANNEL WOULD BE SHORTER THAN 1.2M IN LENGTH TO THE NEAREST JOINT, THEN REMOVE THIS SECTION OF KERB AS WELL AND REPLACE TO MPS STANDARD.

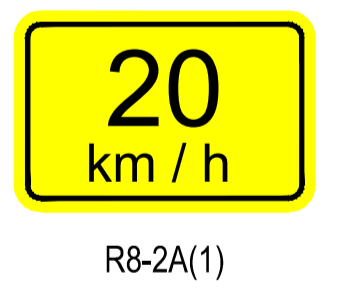

**NO ACCIDENT**

THE CONTRACTOR SHALL BE TOTALLY RESPONSIBLE FOR AND AT ALL TIMES PROVIDE A SAFE WORKING ENVIRONMENT IN THE VICINITY OF THE SITE OF WORKS IN FULL COMPLIANCE WITH THE OCCUPATIONAL HEALTH AND SAFETY REGULATIONS.

**NOTE**  
**TRAFFIC MANAGEMENT**

CONTRACTOR TO SUBMIT TRAFFIC MANAGEMENT PLAN WITH APPLICATION FOR APPROVAL OF TRAFFIC MANAGEMENT PLAN. REFER TO ATTACHED TENDER DOCUMENTS.

**WARNING**  
**BWARE OF UNDERGROUND SERVICES**

THE LOCATION OF EXISTING SERVICES SHOWN ON THESE PLANS ARE APPROXIMATE ONLY AND THEIR EXACT POSITION SHALL BE PROVEN ON SITE. THE APPROPRIATE AUTHORITY SHALL BE CONTACTED AND THE SERVICES LOCATED PRIOR TO COMMENCEMENT OF ANY WORKS. NO GUARANTEE IS GIVEN THAT ALL EXISTING SERVICES ARE SHOWN.

**WARNING**  
**THE LOCATION OF EXISTING UNDERGROUND SERVICES SHOWN ON THESE PLANS ARE APPROXIMATE, THEIR EXACT POSITION MAY VARY FROM THAT SHOWN. THE CONTRACTOR SHALL PROVE THE LOCATION OF ALL SERVICES PRIOR TO THE COMMENCEMENT OF WORKS AND REPORT DISCREPANCIES TO THE SUPERINTENDENT.**

**NOTE**

CONTRACTOR TO EXCAVATE & OPEN PROPOSED PIPE TRENCH TO CONFIRM ALL SERVICE CROSSINGS PRIOR TO CONSTRUCTION/ LAYING OF REINFORCED CONCRETE PIPES.

**DIAL BEFORE YOU DIG**  
www.1100.com.au

**Telstra**  
**WARNING**  
OPTICAL FIBRE IN AREA

**TO CONSTRUCT**

LEGEND			
TELSTRA POLE	FIRE HYDRANT	EX U/GROUND ELECTRICITY CABLE	PROPOSED KERB AND CHANNEL
TELSTRA PIT	WATER STOP VALVE	EX OVERHEAD POWER CABLE	EXISTING KERB AND CHANNEL
PHONE BOX	GAS VALVE	PROPOSED WATER MAIN	PROPOSED PROPERTY INLET
POWER POLE	SEWER MANHOLE	PROPOSED GAS MAIN	TREE
LIGHT POLE	EX WATER MAIN	PROPOSED U/G TELSTRA CABLE	TREE TO BE REMOVED
LANTERN	EX GAS MAIN	PROPOSED SEWER MAIN	PROPOSED DRAINAGE
UNDERGROUND POWER PIT	EX U/GROUND TELSTRA CABLE	PROPOSED EXISTING DRAINAGE	EXISTING DRAINAGE
FIRE PLUG	EX SEWER MAIN	PIT NUMBER	PROPOSED HOUSE DRAIN
		PERMANENT SURVEY MARK	

PLAN APPROVED		COMPUTER REFERENCE	
SIGNED	DATE	PROJECT QA:	23021
DEREK ROTTER	00/00/0000	CONTRACT CN:	2436
MANAGER		CIVIL 3D DWG:	23021
PROJECT DELIVERY		SURVEY:	SURVEYOR
		DESIGN:	PS
		DRAWN:	PS
		CHECKED:	

**MORNINGTON PENINSULA**  
Shire

**DUNNS ROAD**  
MOUNT MARtha

BLACKSPOT - RAISED SAFETY PLATFORMS

TYPICAL DETAILS - RAISED SAFETY PLATFORMS AND TRAFFIC SIGNS

DATUM:	A.H.D.
SCALE AT A1:	AS SHOWN
DATE OF PLAN:	20-02-2024
MELWAYS REF:	145G4
SHEET No. 03 OF 06	
PLAN REF No.	REV
23021-03	A



**RAISED SAFETY PLATFORM - SITE 1**  
SCALE 1:200



**RAISED SAFETY PLATFORM - SITE 2**  
SCALE 1:200



**NOTE**  
**TRAFFIC MANAGEMENT**  
CONTRACTOR TO SUBMIT TRAFFIC MANAGEMENT PLAN WITH APPLICATION FOR APPROVAL OF TRAFFIC MANAGEMENT PLAN. REFER TO ATTACHED TENDER DOCUMENTS.

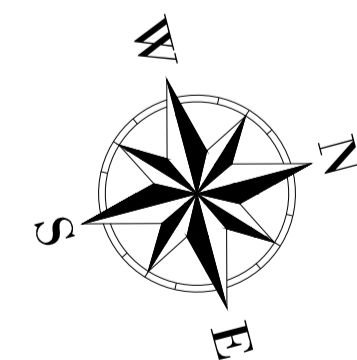
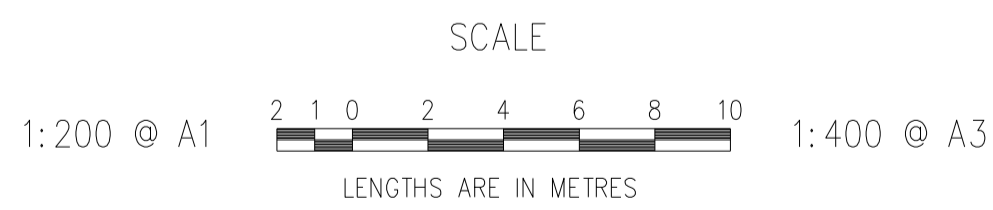

THE CONTRACTOR SHALL BE TOTALLY RESPONSIBLE FOR AND AT ALL TIMES PROVIDE A SAFE WORKING ENVIRONMENT IN THE VICINITY OF THE SITE OF WORKS IN FULL COMPLIANCE WITH THE OCCUPATIONAL HEALTH AND SAFETY REGULATIONS.

**WARNING**  
**BWARE OF UNDERGROUND SERVICES**  
THE LOCATION OF EXISTING SERVICES SHOWN ON THESE PLANS ARE APPROXIMATE ONLY AND THEIR EXACT POSITION SHALL BE PROVEN ON SITE. THE APPROPRIATE AUTHORITY SHALL BE CONTACTED AND THE SERVICES LOCATED PRIOR TO COMMENCEMENT OF ANY WORKS. NO GUARANTEE IS GIVEN THAT ALL EXISTING SERVICES ARE SHOWN.

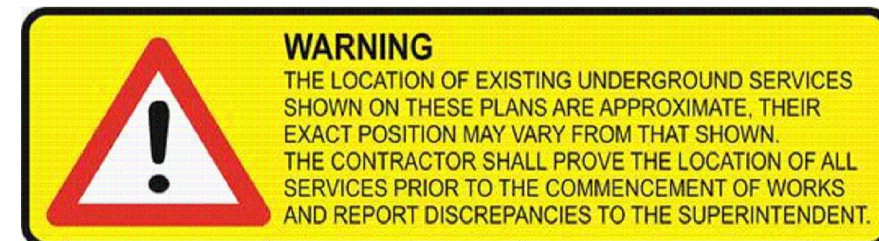

**NOTE**  
CONTRACTOR TO EXCAVATE & OPEN PROPOSED PIPE TRENCH TO CONFIRM ALL SERVICE CROSSINGS PRIOR TO CONSTRUCTION/ LAYING OF REINFORCED CONCRETE PIPES.



**TO CONSTRUCT**

LEGEND			
	TELSTRA POLE		FIRE HYDRANT
	TELSTRA PIT		WATER STOP VALVE
	PHONE BOX		GAS VALVE
	POWER POLE		SEWER MANHOLE
	LIGHT POLE		EX WATER MAIN
	LANTERN		EX GAS MAIN
	UNDERGROUND POWER PIT		EX U/GROUND TELSTRA CABLE
	FIRE PLUG		EX SEWER MAIN
	PROPOSED KERB AND CHANNEL		EXISTING KERB AND CHANNEL
	PROPOSED WATER MAIN		TREE TO BE REMOVED
	PROPOSED GAS MAIN		PROPOSED DRAINAGE
	PROPOSED U/G TELSTRA CABLE		EXISTING DRAINAGE
	PROPOSED SEWER MAIN		PIT NUMBER
	PROPOSED U/G ELECTRICITY CABLE		PROPOSED HOUSE DRAIN
	PERMANENT SURVEY MARK		

PLAN APPROVED	H			
SIGNED	G			
	F			
	E			
	D			
	C			
	B			
DEREK ROTTER MANAGER	A	00/00/00	BY	STAGE
PROJECT DELIVERY	No	DATE	BY	STAGE

COMPUTER REFERENCE	
PROJECT QA:	23021
CONTRACT CN:	2436
CIVIL 3D DWG:	23021
SURVEY:	SURVEYOR
DESIGN:	PS
DRAWN:	PS
CHECKED:	



DUNNS ROAD  
MOUNT MARtha  
BLACKSPORT - RAISED SAFETY PLATFORMS  
PROPOSED RAISED SAFETY PLATFORMS AT DUNNS ROAD

DATUM:	A.H.D.
SCALE AT A1:	AS SHOWN
DATE OF PLAN:	20-02-2024
MELWAYS REF:	145G4
SHEET No. 04 OF 06	
PLAN REF No.	REV
23021-04	A



RAISED SAFETY PLATFORM - SITE 3  
SCALE 1:200

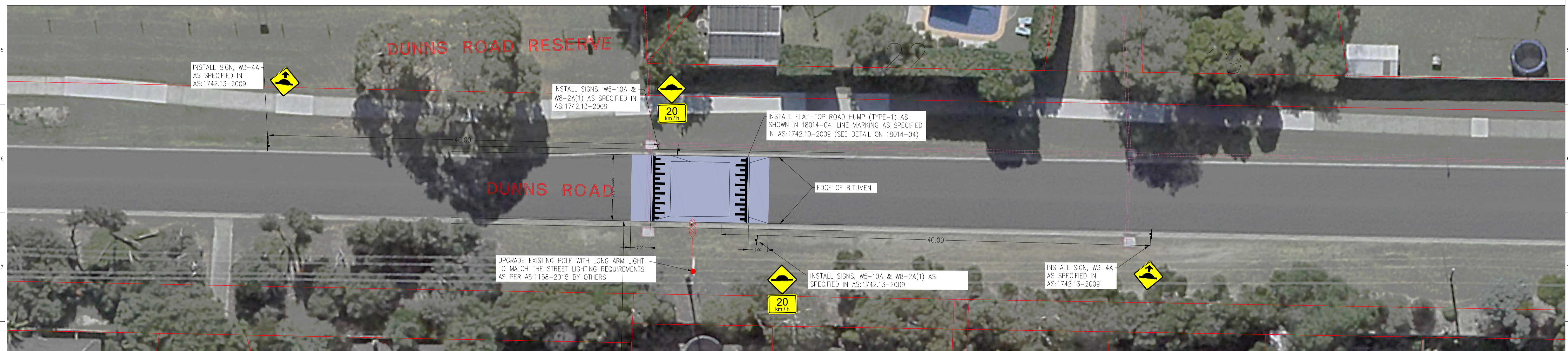

RAISED SAFETY PLATFORM - SITE 4  
SCALE 1:200



**NOTE**  
**TRAFFIC MANAGEMENT**  
CONTRACTOR TO SUBMIT TRAFFIC MANAGEMENT PLAN WITH APPLICATION FOR APPROVAL OF TRAFFIC MANAGEMENT PLAN. REFER TO ATTACHED TENDER DOCUMENTS.

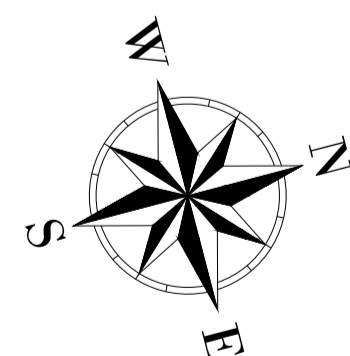
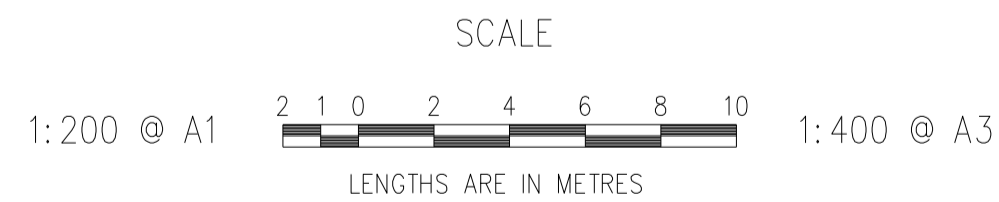

**NOTE**  
CONTRACTOR TO EXCAVATE & OPEN PROPOSED PIPE TRENCH TO CONFIRM ALL SERVICE CROSSINGS PRIOR TO CONSTRUCTION/ LAYING OF REINFORCED CONCRETE PIPES.



**TO CONSTRUCT**

LEGEND			
	TELSTRA POLE		FIRE HYDRANT
	TELSTRA PIT		WATER STOP VALVE
	PHONE BOX		GAS VALVE
	POWER POLE		SEWER MANHOLE
	LIGHT POLE		EX WATER MAIN
	LANTERN		EX GAS MAIN
	UNDERGROUND POWER PIT		EX U/GROUND TELSTRA CABLE
	FIRE PLUG		EX SEWER MAIN
	EX U/GROUND ELECTRICITY CABLE		PROPOSED KERB AND CHANNEL
	EX OVERHEAD POWER CABLE		EXISTING KERB AND CHANNEL
	PROPOSED WATER MAIN		TREE
	PROPOSED GAS MAIN		TREE TO BE REMOVED
	PROPOSED U/G TELSTRA CABLE		PROPOSED DRAINAGE
	PROPOSED SEWER MAIN		EXISTING DRAINAGE
	PROPOSED U/G ELECTRICITY CABLE		PIT NUMBER
	PERMANENT SURVEY MARK		PROPOSED HOUSE DRAIN
	EXISTING HOUSE DRAIN		PROPOSED PROPERTY INLET

PLAN APPROVED	H						
SIGNED	G						
	F						
	E						
	D						
	C						
	B						
DEREK ROTTER MANAGER	A	00/00/00	BY	STAGE			
PROJECT DELIVERY	No	DATE	BY	STAGE			
	DRAWING REVISION DETAILS						

COMPUTER REFERENCE	
PROJECT QA:	23021
CONTRACT CN:	2436
CIVIL 3D DWG:	23021
SURVEY:	SURVEYOR
DESIGN:	PS
DRAWN:	PS
CHECKED:	



DUNNS ROAD  
MOUNT MARTHA  
BLACKSPORT PROJECT  
PROPOSED RAISED SAFETY PLATFORMS AT DUNNS ROAD

DATUM:	A.H.D.
SCALE AT A1:	AS SHOWN
DATE OF PLAN:	20-02-2024
MELWAYS REF:	145G4
SHEET No. 05 OF 06	
PLAN REF No.	REV
23021-05	A

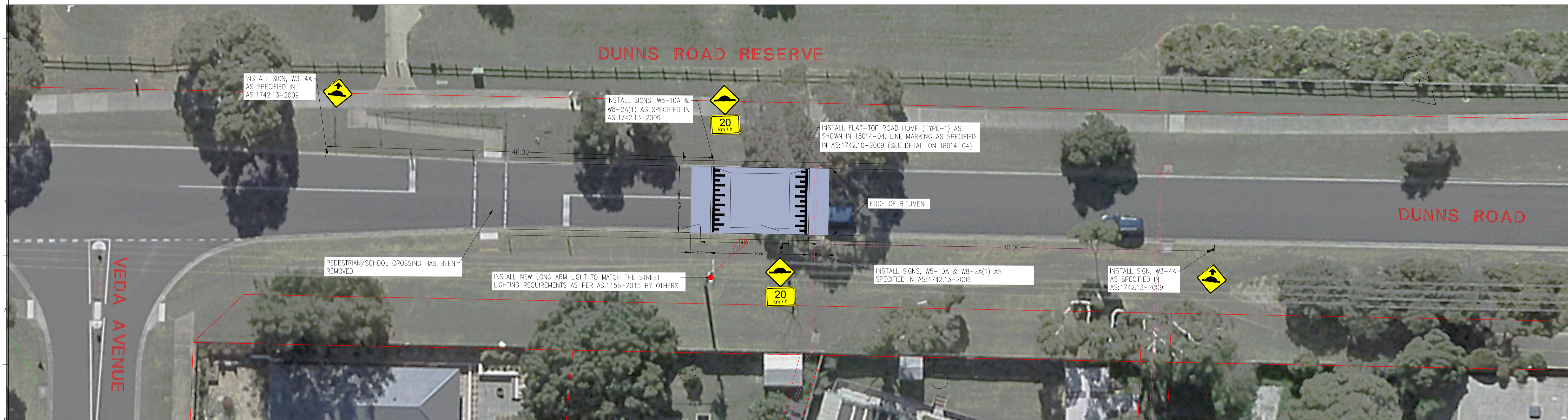

RAISED SAFETY PLATFORM - SITE 5  
SCALE 1:200

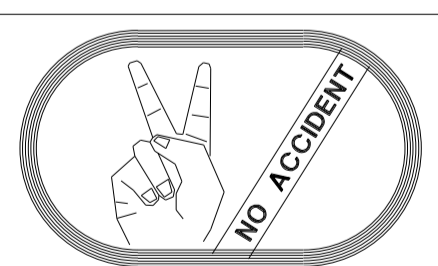

**NOTE**  
**TRAFFIC MANAGEMENT**  
CONTRACTOR TO SUBMIT TRAFFIC MANAGEMENT PLAN WITH APPLICATION FOR APPROVAL OF TRAFFIC MANAGEMENT PLAN. REFER TO ATTACHED TENDER DOCUMENTS.

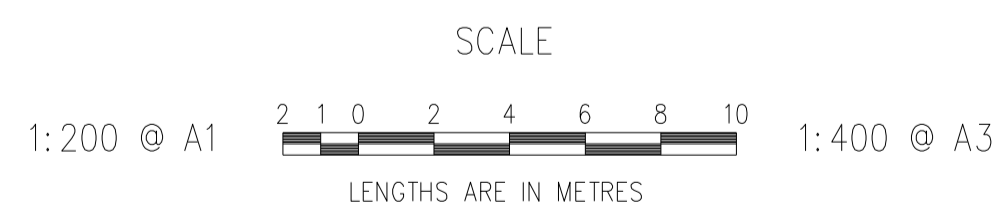

**WARNING**  
**BEWARE OF UNDERGROUND SERVICES**  
THE LOCATION OF EXISTING SERVICES SHOWN ON THESE PLANS ARE APPROXIMATE ONLY AND THEIR EXACT POSITION SHALL BE PROVEN ON SITE. THE APPROPRIATE AUTHORITY SHALL BE CONTACTED AND THE SERVICES LOCATED PRIOR TO COMMENCEMENT OF ANY WORKS. NO GUARANTEE IS GIVEN THAT ALL EXISTING SERVICES ARE SHOWN.

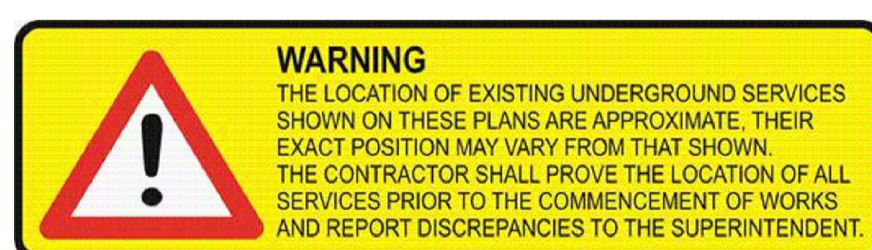

**NOTE**  
CONTRACTOR TO EXCAVATE & OPEN PROPOSED PIPE TRENCH TO CONFIRM ALL SERVICE CROSSINGS PRIOR TO CONSTRUCTION/ LAYING OF REINFORCED CONCRETE PIPES.



**TO CONSTRUCT**

LEGEND			
	TELSTRA POLE		FIRE HYDRANT
	TELSTRA PIT		WATER STOP VALVE
	PHONE BOX		GAS VALVE
	POWER POLE		SEWER MANHOLE
	LIGHT POLE		EX WATER MAIN
	LANTERN		EX GAS MAIN
	UNDERGROUND POWER PIT		EX U/GROUND TELSTRA CABLE
	FIRE PLUG		EX SEWER MAIN
	EX U/GROUND ELECTRICITY CABLE		PROPOSED WATER MAIN
	EX OVERHEAD POWER CABLE		PROPOSED GAS MAIN
	PROPOSED KERB AND CHANNEL		PROPOSED U/G TELSTRA CABLE
	EXISTING KERB AND CHANNEL		PROPOSED SEWER MAIN
	TREE		PROPOSED U/G ELECTRICITY CABLE
	TREE TO BE REMOVED		EXISTING DRAINAGE
	PROPOSED PROPERTY INLET		PIT NUMBER
	EXISTING HOUSE DRAIN		PROPOSED HOUSE DRAIN
	PERMANENT SURVEY MARK		

PLAN APPROVED	H				
SIGNED	G				
DEREK ROTTER	F				
MANAGER	E				
PROJECT DELIVERY	D				
	C				
	B				
	A	00/00/00	BY	STAGE	
	No	DATE	BY		
					DRAWING REVISION DETAILS

COMPUTER REFERENCE	
PROJECT QA:	23021
CONTRACT CN:	2436
CIVIL 3D DWG:	23021
SURVEY:	SURVEYOR
DESIGN:	PS
DRAWN:	PS
CHECKED:	



DUNNS ROAD  
MOUNT MARtha  
BLACKSPORT PROJECT  
PROPOSED RAISED SAFETY PLATFORMS AT DUNNS ROAD

DATUM:	A.H.D.
SCALE AT A1:	AS SHOWN
DATE OF PLAN:	20-02-2024
MELWAYS REF:	145G4
SHEET No. 06 OF 06	
PLAN REF No.	REV
23021-06	A