

FOR CONTINUATION REFER TO SHEET No. 2 - INSET A

FOR CONTINUATION REFER TO SHEET No. 2

**NOTE**  
PROPOSED SIGNAL HARDWARE LOCATIONS ARE INDICATIVE ONLY.  
THE ACTUAL LOCATION OF PROPOSED PEDESTALS, CONDUIT PITS, CONDUITS, ETC. SHALL BE DETERMINED ON SITE AT THE PRE-INSTALLATION MEETING.

**PRELIMINARY PLAN**  
FOR DISCUSSION PURPOSES ONLY  
SUBJECT TO CHANGE WITHOUT NOTIFICATION  
DATE OF ISSUE: 26/06/20

**WARNING**  
BEWARE OF UNDERGROUND SERVICES  
THE LOCATIONS OF UNDERGROUND SERVICES ARE APPROXIMATE ONLY AND THEIR EXACT POSITION SHOULD BE PROVEN ON SITE. NO GUARANTEE IS GIVEN THAT ALL EXISTING SERVICES ARE SHOWN.

ISSUE	APP'D	DATE	AMENDMENT
P8		26.06.20	VICROADS COMMENTS
P7		30.04.20	STAKEHOLDER COMMENTS
P6		28.04.20	VENTURA COMMENTS
P5		08.04.20	PTV COMMENTS
P4		26.02.20	ROAD SAFETY AUDIT COMMENTS

**GENERAL NOTES**

1. BASE INFORMATION FROM MORNINGTON PENINSULA SHIRE SURVEY FILE 17091 Bes-Bon Aquatic.DWG.
2. ALL DIMENSIONS ARE TO FACE OF KERB UNLESS SHOWN OTHERWISE.
3. PUBLIC LIGHTING REFER TO TRAFFICWORKS DRAWING 170215-PLD-30-31-P1.

DESIGNED  
A ALEXANDROV JAN 2020

APPROVED  
C GIST JAN 2020

SCALE  
HOR 0 5 10  
METRES VER

**TRAFFICWORKS**  
PTY LTD

1st Floor 132 Upper Heidelberg Road IVANHOE VIC. 3079  
P.O. Box 417 IVANHOE VIC. 3079  
Tel (03) 9490 5900 Fax (03) 9490 5910 www.trafficworks.com.au

CLIENT  
**FMG ENGINEERING**

**BONEO ROAD / BESGROVE STREET / ALLAMBI AVENUE**  
MORNINGTON PENINSULA SHIRE  
**INTERSECTION FUNCTIONAL LAYOUT**

SHEET NO. 1 DRAWING NO. 170215-FLT-01 ISSUE P8

26/06/2020 170215-FLT-01 3:57:02 PM T:\1718 Projects\170215\Design\170215-FLT-01-03-p8.dgn

117

SIGN SCHEDULE

#2		R1-2	#16		R2-5	#20		#22		R6-6	#26		R2-6(R)	
#3		R2-3(L)	#17					#23		R4-1-70	#27		R2-14(L)	
#4		D4-1-2(L)	#18		R4-1-40			#24		R2-4	#28			
#11		R2-6(L)	#19		R4-1-50	#21		R4-V106	#25		W5-10	#29		
#13		R2-2(L)								W8-2				
#14		R2-2(R)									#30		R2-11	
												#30	INFORMATIVE	

RESIDENTIAL

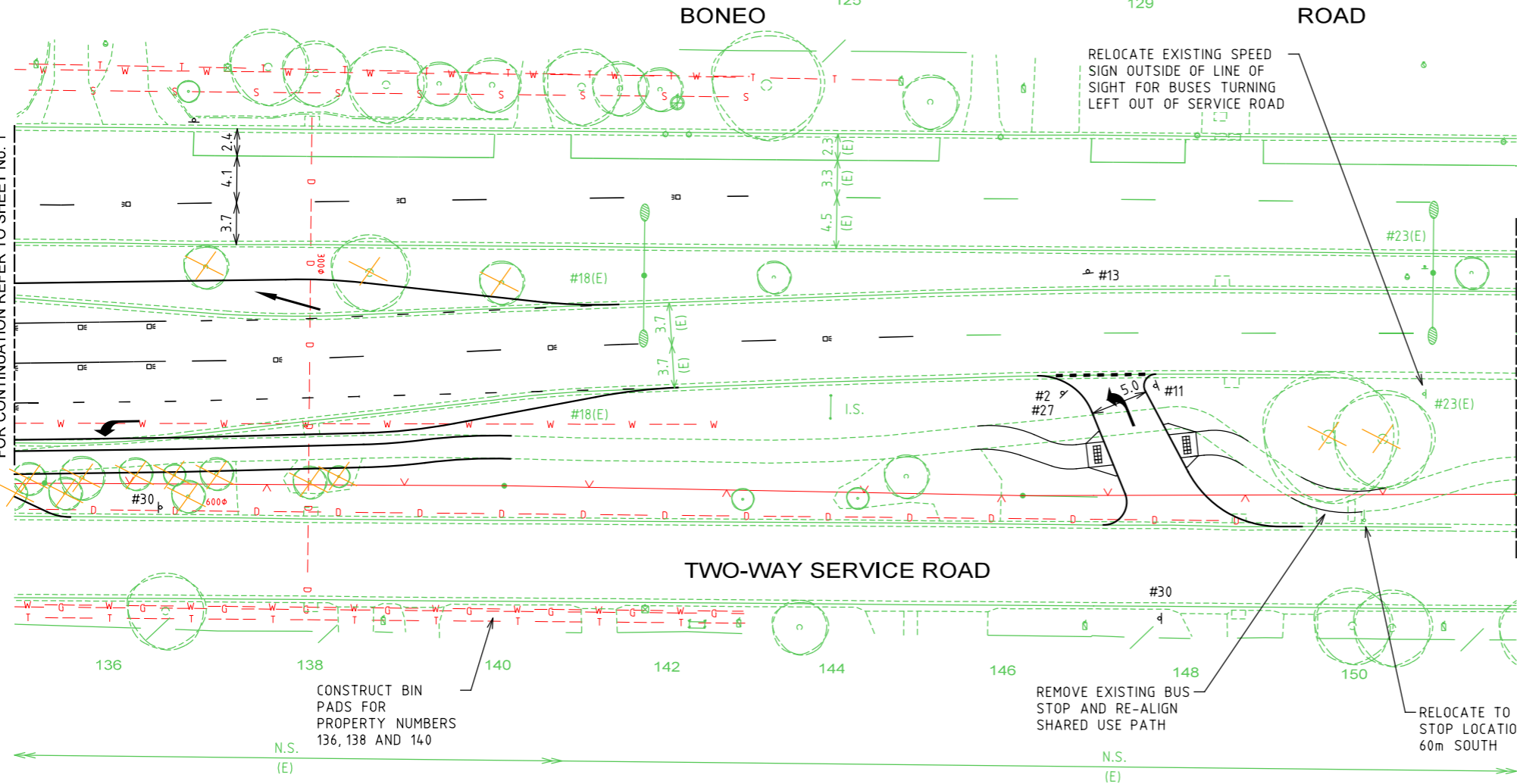

INSET A

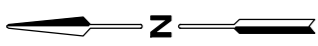
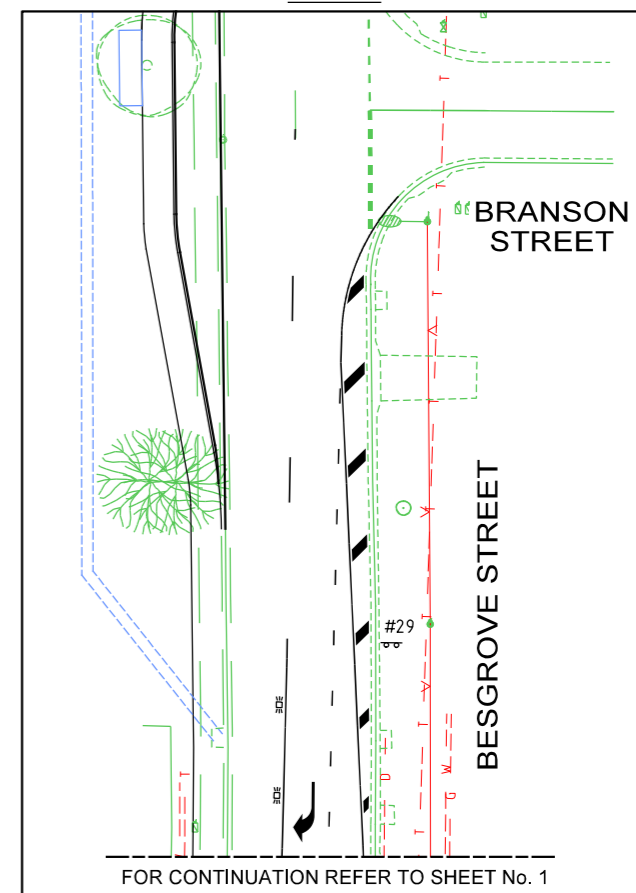

MELWAY MAP 170 A4 ROSEBUD

REMOVE EXISTING TREES



**PRELIMINARY PLAN**  
FOR DISCUSSION PURPOSES ONLY  
SUBJECT TO CHANGE WITHOUT NOTIFICATION  
DATE OF ISSUE: 26/06/20

**WARNING**  
BEWARE OF UNDERGROUND SERVICES  
THE LOCATIONS OF UNDERGROUND SERVICES ARE APPROXIMATE ONLY AND THEIR EXACT POSITION SHOULD BE PROVEN ON SITE. NO GUARANTEE IS GIVEN THAT ALL EXISTING SERVICES ARE SHOWN.

26/06/2020 170215-FLT-02 3:59:59 PM T:\1718 Projects\170215\Design\170215-FLT-01-03-p8.dgn

ISSUE	APP'D	DATE	AMENDMENT
P8		26.06.20	VICROADS COMMENTS
P7		30.04.20	STAKEHOLDER COMMENTS
P6		28.04.20	VENTURA COMMENTS
P5		08.04.20	PTV COMMENTS
P4		26.02.20	ROAD SAFETY AUDIT COMMENTS

GENERAL NOTES

1. BASE INFORMATION FROM MORNINGTON PENINSULA SHIRE SURVEY FILE 17091 Bes-Bon Aquatic.DWG.
2. ALL DIMENSIONS ARE TO FACE OF KERB UNLESS SHOWN OTHERWISE.

DESIGNED  
A ALEXANDROV JAN 2020

APPROVED  
C GIST JAN 2020

SCALE HOR 0 5 10  
of METRES VER

**TRAFFICWORKS** PTY LTD

1st Floor 132 Upper Heidelberg Road IVANHOE VIC. 3079  
P.O. Box 417 IVANHOE VIC. 3079  
Tel (03) 9490 5900 Fax (03) 9490 5910 www.trafficworks.com.au

CLIENT  
**FMG ENGINEERING**

**BONEO ROAD / BESGROVE STREET / ALLAMBI AVENUE**  
MORNINGTON PENINSULA SHIRE  
**INTERSECTION FUNCTIONAL LAYOUT**

SHEET NO. 2 DRAWING NO. 170215-FLT-02 ISSUE P8

